

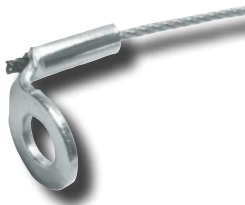

# 90 DEGREE EYELETS

Duro Dyne Dyna-Tite eyelets are manufactured of zinc plated cold rolled steel and swaged to the wire rope cable with a hydraulic press. Dyna-Tite Eyelet assemblies are available for installation with either a 1/4 in. or 3/8 in. fastener. They are available in 45°, 90° and straight variations and can also be purchased as a package with the appropriate cable lock.



**Also Available  
in Kits with  
Dyna-Tite  
Cable Locks.**

Item#	Code	Description	For Use With	Safe Working Load*†	Quantity
<b>1/4 in. Eyelets</b>					
30140	9014-05WC2	90° 1/4 in. Eyelet - 5 ft. x WC2-CL6 Wire Rope	CL6-WC2	10-75 lbs. (5-34 kg)	10/bag-10bg/ ctn
30141	9014-10WC2	90° 1/4 in. Eyelet - 10 ft. x WC2-CL6 Wire Rope	CL6-WC2	10-75 lbs. (5-34 kg)	10/bag-10bg/ ctn
30142	9014-15WC2	90° 1/4 in. Eyelet - 15 ft. x WC2-CL6 Wire Rope	CL6-WC2	10-75 lbs. (5-34 kg)	10/bag-10bg/ ctn
30143	9014-25WC2	90° 1/4 in. Eyelet - 25 ft. x WC2-CL6 Wire Rope	CL6-WC2	10-75 lbs. (5-34 kg)	5/bag-10bg/ ctn
30144	9014-05WC3	90° 1/4 in. Eyelet - 5 ft. x WC3-CL12 Wire Rope	CL12-WC3	25-150 lbs. (12-68 kg)	10/bag-10bg/ ctn
30145	9014-10WC3	90° 1/4 in. Eyelet - 10 ft. x WC3-CL12 Wire Rope	CL12-WC3	25-150 lbs. (12-68 kg)	10/bag-10bg/ ctn
30146	9014-15WC3	90° 1/4 in. Eyelet - 15 ft. x WC3-CL12 Wire Rope	CL12-WC3	25-150 lbs. (12-68 kg)	10/bag-10bg/ ctn
30147	9014-25WC3	90° 1/4 in. Eyelet - 25 ft. x WC3-CL12 Wire Rope	CL12-WC3	25-150 lbs. (12-68 kg)	5/bag-10bg/ ctn
30148	9014-05WC4	90° 1/4 in. Eyelet - 5 ft. x WC4-CL18 Wire Rope	CL18-WC4	25-250 lbs. (12-114 kg)	10/bag-10bg/ ctn
30149	9014-10WC4	90° 1/4 in. Eyelet - 10 ft. x WC4-CL18 Wire Rope	CL18-WC4	25-250 lbs. (12-114 kg)	10/bag-10bg/ ctn
30150	9014-15WC4	90° 1/4 in. Eyelet - 15 ft. x WC4-CL18 Wire Rope	CL18-WC4	25-250 lbs. (12-114 kg)	10/bag-10bg/ ctn
30151	9014-25WC4	90° 1/4 in. Eyelet - 25 ft. x WC4-CL18 Wire Rope	CL18-WC4	25-250 lbs. (12-114 kg)	5/bag-10bg/ ctn
<b>3/8 in. Eyelets</b>					
30152	9038-05WC3	90° 3/8 in. Eyelet - 5 ft. x WC3-CL12 Wire Rope	CL12-WC3	25-150 lbs. (12-68 kg)	10/bag-10bg/ ctn
30153	9038-10WC3	90° 3/8 in. Eyelet - 10 ft. x WC3-CL12 Wire Rope	CL12-WC3	25-150 lbs. (12-68 kg)	10/bag-10bg/ ctn
30154	9038-15WC3	90° 3/8 in. Eyelet - 15 ft. x WC3-CL12 Wire Rope	CL12-WC3	25-150 lbs. (12-68 kg)	10/bag-10bg/ ctn
30155	9038-25WC3	90° 3/8 in. Eyelet - 25 ft. x WC3-CL12 Wire Rope	CL12-WC3	25-150 lbs. (12-68 kg)	5/bag-10bg/ ctn
30157	9038-05WC4	90° 3/8 in. Eyelet - 5 ft. x WC4-CL18 Wire Rope	CL18-WC4	25-250 lbs. (12-114 kg)	10/bag-10bg/ ctn
30158	9038-10WC4	90° 3/8 in. Eyelet - 10 ft. x WC4-CL18 Wire Rope	CL18-WC4	25-250 lbs. (12-114 kg)	10/bag-10bg/ ctn
30159	9038-15WC4	90° 3/8 in. Eyelet - 15 ft. x WC4-CL18 Wire Rope	CL18-WC4	25-250 lbs. (12-114 kg)	10/bag-10bg/ ctn
30160	9038-25WC4	90° 3/8 in. Eyelet - 25 ft. x WC4-CL18 Wire Rope	CL18-WC4	25-250 lbs. (12-114 kg)	5/bag-10bg/ ctn
*Safe Working Loads are based on a 5:1 Safety Factor.					
†Hanging at angles will reduce the Safe Working Loads. Please see our 'Effects of Hanging at Angles' table <a href="http://www.durodyne.com/DTTesting.php">http://www.durodyne.com/DTTesting.php</a>					

Please visit our website [www.durodyne.com](http://www.durodyne.com) for the most current product information.

Duro Dyne Corporate Headquarters, Bay Shore, NY  
631-249-9000 • Fax: 631-249-8346

Duro Dyne Midwest • Duro Dyne West • Duro Dyne Canada  
[www.durodyne.com](http://www.durodyne.com) • E-mail: [durodyne@durodyne.com](mailto:durodyne@durodyne.com)





# 45 DEGREE EYELETS

Duro Dyne Dyna-Tite eyelets are manufactured of zinc plated cold rolled steel and swaged to the wire rope cable with a hydraulic press. Dyna-Tite Eyelet assemblies are available for installation with either a 1/4 in. or 3/8 in. fastener. They are available in 45°, 90° and straight variations and can also be purchased as a package with the appropriate cable lock.



**Also Available  
in Kits with  
Dyna-Tite  
Cable Locks.**

Item#	Code	Description	For Use With	Safe Working Load*±	Quantity
<b>1/4 in. Eyelets</b>					
30161	4514-05WC2	45° 1/4 in. Eyelet - 5 ft. x WC2-CL6 Wire Rope	CL6-WC2	10-75 lbs. (5-34 kg)	10/bag-10bg/ ctn
30162	4514-10WC2	45° 1/4 in. Eyelet - 10 ft. x WC2-CL6 Wire Rope	CL6-WC2	10-75 lbs. (5-34 kg)	10/bag-10bg/ ctn
30164	4514-25WC2	45° 1/4 in. Eyelet - 25 ft. x WC2-CL6 Wire Rope	CL6-WC2	10-75 lbs. (5-34 kg)	5/bag-10bg/ ctn
30165	4514-05WC3	45° 1/4 in. Eyelet - 5 ft. x WC3-CL12 Wire Rope	CL12-WC3	25-150 lbs. (12-68 kg)	10/bag-10bg/ctn
30166	4514-10WC3	45° 1/4 in. Eyelet - 10 ft. x WC3-CL12 Wire Rope	CL12-WC3	25-150 lbs. (12-68 kg)	10/bag-10bg/ctn
30167	4514-15WC3	45° 1/4 in. Eyelet - 15 ft. x WC3-CL12 Wire Rope	CL12-WC3	25-150 lbs. (12-68 kg)	10/bag-10bg/ctn
30168	4514-25WC3	45° 1/4 in. Eyelet - 25 ft. x WC3-CL12 Wire Rope	CL12-WC3	25-150 lbs. (12-68 kg)	5/bag-10bg/ctn
30169	4514-05WC4	45° 1/4 in. Eyelet - 5 ft. x WC4-CL18 Wire Rope	CL18-WC4	25-250 lbs. (12-114 kg)	10/bag-10bg/ctn
30170	4514-10WC4	45° 1/4 in. Eyelet - 10 ft. x WC4-CL18 Wire Rope	CL18-WC4	25-250 lbs. (12-114 kg)	10/bag-10bg/ctn
<b>3/8 in. Eyelets</b>					
30174	4538-10WC3	45° 3/8 in. Eyelet - 10 ft. x WC3-CL12 Wire Rope	CL12-WC3	25-150 lbs. (12-68 kg)	10/bag-10bg/ctn
30175	4538-15WC3	45° 3/8 in. Eyelet - 15 ft. x WC3-CL12 Wire Rope	CL12-WC3	25-150 lbs. (12-68 kg)	10/bag-10bg/ctn
30176	4538-25WC3	45° 3/8 in. Eyelet - 25 ft. x WC3-CL12 Wire Rope	CL12-WC3	25-150 lbs. (12-68 kg)	5/bag-10bg/ctn
30177	4538-05WC4	45° 3/8 in. Eyelet - 5 ft. x WC4-CL18 Wire Rope	CL18-WC4	25-250 lbs. (12-114 kg)	10/bag-10bg/ctn
30179	4538-15WC4	45° 3/8 in. Eyelet - 15 ft. x WC4-CL18 Wire Rope	CL18-WC4	25-250 lbs. (12-114 kg)	10/bag-10bg/ctn
30180	4538-25WC4	45° 3/8 in. Eyelet - 25 ft. x WC4-CL18 Wire Rope	CL18-WC4	25-250 lbs. (12-114 kg)	5/bag-10bg/ ctn
*Safe Working Loads are based on a 5:1 Safety Factor.					
±Hanging at angles will reduce the Safe Working Loads. Please see our 'Effects of Hanging at Angles' table <a href="http://www.durodyne.com/DTTesting.php">http://www.durodyne.com/DTTesting.php</a>					

Please visit our website [www.durodyne.com](http://www.durodyne.com) for the most current product information.

Duro Dyne Corporate Headquarters, Bay Shore, NY

631-249-9000 • Fax: 631-249-8346

Duro Dyne Midwest • Duro Dyne West • Duro Dyne Canada

[www.durodyne.com](http://www.durodyne.com) • E-mail: [durodyne@durodyne.com](mailto:durodyne@durodyne.com)



© Duro Dyne Corp.  
Printed in USA 10/2019



# STRAIGHT EYELETS

Duro Dyne Dyna-Tite eyelets are manufactured of zinc plated cold rolled steel and swaged to the wire rope cable with a hydraulic press. Dyna-Tite Eyelet assemblies are available for installation with either a 1/4 in. or 3/8 in. fastener. They are available in 45°, 90° and straight variations and can also be purchased as a package with the appropriate cable lock.



Item#	Code	Description	For Use With	Safe Working Load*+	Quantity
<b>1/4 in. Eyelets</b>					
30110	S14-05WC2	Straight 1/4 in. Eyelet - 5 ft. x WC2-CL6 Wire Rope	CL6-WC2	10-75 lbs. (5-34 kg)	10/bag-10bg/ctn
30111	S14-10WC2	Straight 1/4 in. Eyelet - 10 ft. x WC2-CL6 Wire Rope	CL6-WC2	10-75 lbs. (5-34 kg)	10/bag-10bg/ctn
30116	S14-15WC2	Straight 1/4 in. Eyelet - 15 ft. x WC2-CL6 Wire Rope	CL6-WC2	10-75 lbs. (5-34 kg)	10/bag-10bg/ctn
30122	S14-05WC3	Straight 1/4 in. Eyelet - 5 ft. x WC3-CL12 Wire Rope	CL12-WC3	25-150 lbs. (12-68 kg)	10/bag-10bg/ctn
30123	S14-10WC3	Straight 1/4 in. Eyelet - 10 ft. x WC3-CL12 Wire Rope	CL12-WC3	25-150 lbs. (12-68 kg)	10/bag-10bg/ctn
30128	S14-15WC3	Straight 1/4 in. Eyelet - 15 ft. x WC3-CL12 Wire Rope	CL12-WC3	25-150 lbs. (12-68 kg)	10/bag-10bg/ctn
30129	S14-25WC3	Straight 1/4 in. Eyelet - 25 ft. x WC3-CL12 Wire Rope	CL12-WC3	25-150 lbs. (12-68 kg)	5/bag-10bg/ctn
*Safe Working Loads are based on a 5:1 Safety Factor.					
+Hanging at angles will reduce the Safe Working Loads. Please see our 'Effects of Hanging at Angles' table <a href="http://www.durodyne.com/DTTesting.php">http://www.durodyne.com/DTTesting.php</a>					

Please visit our website [www.durodyne.com](http://www.durodyne.com) for the most current product information.

Duro Dyne Corporate Headquarters, Bay Shore, NY

631-249-9000 • Fax: 631-249-8346

Duro Dyne Midwest • Duro Dyne West • Duro Dyne Canada

[www.durodyne.com](http://www.durodyne.com) • E-mail: [durodyne@durodyne.com](mailto:durodyne@durodyne.com)



© Duro Dyne Corp.  
Printed in USA 10/2019